

BEZBEDNOŠNA TEHNOLOGIJA
ZA ZAŠTITU ŽIVOTNE SREDINE

SAFETY AND
ENVIRONMENTAL
TECHNOLOGY

E.L.B.
FÜLLSTANDSGERÄTE



01-01-04E

Uronjene Magnetne Sonde Serija T-20...F

Bivša Kategorija oblasti 1 (Bivša Zona 0)

TIP T-20...F

EG-EC Sertifikat za Ispitivanje tipa

TÜV 02 ATEX 1795 X

sa opštim odobrenjem za
konstruisanje Z-65.11-404



Immersible Magnetic Probes Series T-20...F

Ex Area Category 1 (Ex Zone 0)

EC Type-Examination Certificate

TÜV 02 ATEX 1795 X

with general approval for
construction Z-65.11-404

Kljuc tipa

Osnovne oznake (spoj cevi i zavrtnja, nerdjajući celik 1.4571)
Uronjene magnetne sonde - nerdjajući celik

- Precnik cevi sonde
3 = cev Ø 15mm
4 = cev Ø 12mm
9/0 = cev Ø 18mm
4/0 = cev Ø 12 mm (nepovezan kraj kabla)
5/0 = cev Ø 8mm (nepovezan kraj kabla)
- Bezbednosne funkcije*
F = Deo sistema za zaštitu od prepunavanja
Cilindricni navoj (konicni na zahtev)
I 1/8" = G 1/8" za unutrašnju montažu
I 1/2" = G 1/2" za unutrašnju montažu
A 1/2" = G 1/2" za spoljašnju montažu
A 1" = G 1" za spoljašnju montažu
A 1 1/4" = G 1 1/4" za spoljašnju montažu
A 1 1/2" = G 1 1/2" za spoljašnju montažu
A 2" = G 2" za spoljašnju montažu
A 3" = G 3" za spoljašnju montažu
S = Specijalni zahtevi (jezicak)
- Dizajn
bez indikacija = fiksni
V = podesiv (samo sa spoljašnjim navojem)
- Dodatne trajne uronjene sonde
bez indikacija = nema
K = trajne uronjene sonde (pocinju od cevi Ø12mm)
- Broj plovača
1x = 1 plovak
2x = 2 plovača itd.
- Modeli plovača
02 = kugla, nerdjajući celik 44 mm Ø
03 = kugla, nerdjajući celik 52 mm Ø
04 = kugla, nerdjajući celik 62 mm Ø
05 = ovalni plovak, nerdjajući celik 80 mm Ø
06 = ovalni plovak, nerdjajući celik 94 mm Ø
07 = kugla, nerdjajući celik 105 mm Ø
08 = cilindar, nerdjajući celik 27 mm Ø
09 = cilindar, nerdjajući celik 44 mm Ø
- Veza
PO = Kutija od poliestera
AA = Kutija od aluminijuma
EX = mm kabl PUR plavi (standard 1000mm)
- Tip Ex zaštite
IIC = ATEX II 1 G EEx ia IIC T6
po redu II 1/2 G EEx ia IIC T6
- Dužina LF u mm
mm

T20 F IIC

Type Key

Basic indication (pipe and screw union Stainless steel 1.4571)
Immersible magnetic probe - Stainless steel

- Probe pipe diameter
3 = pipe Ø 15mm
4 = pipe Ø 12mm
9/0 = pipe Ø 18mm
4/0 = pipe Ø 12mm (unconnected cable end)
5/0 = pipe Ø 8mm (unconnected cable end)
- Safety function*
F = Part of an overflow protection system
Thread cylindrical (on request conical)
I 1/8" = G 1/8" for internal assembly
I 1/2" = G 1/2" for internal assembly
A 1/2" = G 1/2" for external assembly
A 1" = G 1" for external assembly
A 1 1/4" = G 1 1/4" for external assembly
A 1 1/2" = G 1 1/2" for external assembly
A 2" = G 2" for external assembly
A 3" = G 3" for external assembly
S = Special request (flange)
- Design
without indication = fixed
V = adjustable (only with external thread)
- Additional continuous immersible probes
without indication = none
K = continuous immersible probes (starting from pipe Ø12 mm)
- No. of Floats
1x = 1 float
2x = 2 floats etc.
- Float Models
02 = ball Stainless steel 44 mm Ø
03 = ball Stainless steel 52 mm Ø
04 = ball Stainless steel 62 mm Ø
05 = oval float Stainless steel 80 mm Ø
06 = oval float Stainless steel 94 mm Ø
07 = ball Stainless steel 105 mm Ø
08 = cylinder Stainless steel 27 mm Ø
09 = cylinder Stainless steel 44 mm Ø
- Connection
PO = Polyester box
AA = Aluminium box
EX = mm cable PUR blue (standard 1000 mm)
- Ex protection type
IIC = ATEX II 1 G EEx ia IIC T6
resp. II 1/2 G EEx ia IIC T6
- LF length in mm
mm

T20 F IIC

* Posebno odobrene od strane DIBt kao uredjaju za zaštitu od preopterećenja za tecnosti koje zagadjuju vodu

* Separate approval by the DIBt as overflow protection device for water-endangering liquids



Kutije spojnice ugradjene na spoljasnji zid zavrtnja Connection boxes mounted on external screw union

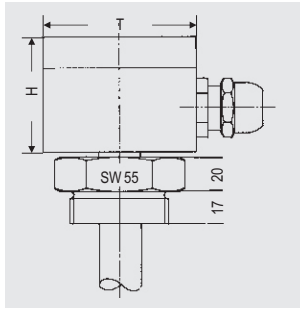

Typ / Type
RVA-VVA-A1½"-AA(PO) = Cev zavarena
Pipe welded

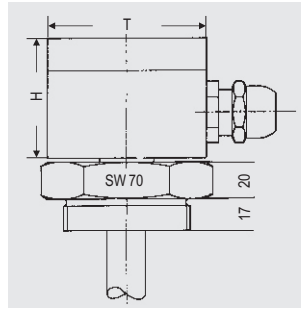

Typ / Type
RVA-VVA-A2"-AA(PO) = Cev zavarena
Pipe welded

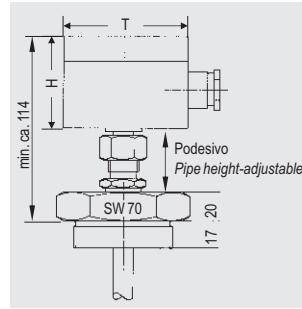

Typ / Type
RVA-VVA-A2"-AA(PO)-V = Obezbedjeno
spojem cevi
Secured with
tube union

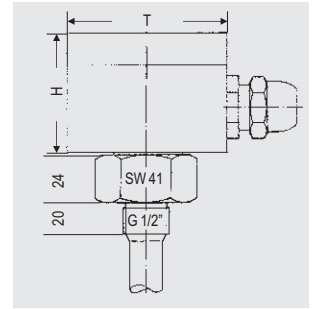

Typ / Type
RVA-VVA-A½"-AA(PO) = Cev zavarena
Pipe welded

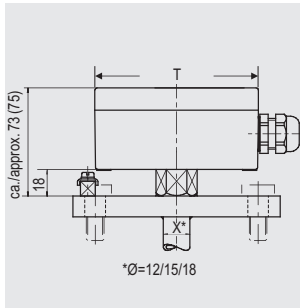

Typ / Type
RVA-FVA-1x-AA(PO) = Deo na spoju
zavaren
Connecting piece
welded

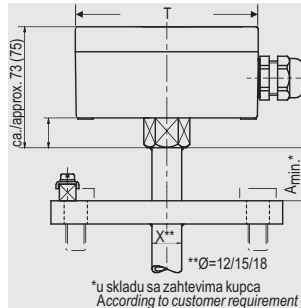

Typ / Type
RVA-FVA-1x-AA(PO)-H = Deo na spoju
zavaren, kutija
spojnice zavarena
Connecting piece
welded, connector
box raised

Legenda / Legend

Dimenzije u mm / Dimensioning in mm

- RVA = Nerdjajuci celik / Stainless steel pipe
- VVA = Spoj od nerd. celika 1.4571 / Stainless steel union 1.4571
- A½" = Navoj G½" za spoljasnju montazu / Thread G½" for external assembly
- A1½" = Navoj G1½" za spoljasnju montazu / Thread G1½" for external assembly
- A2" = Navoj G2" za spoljasnju montazu / Thread G2" for external assembly
- AA = Aluminijumska kutija / Aluminum box
- PO = Kutija od poliestera / Polyester box
- V = Podesivo / Adjustable

Specijalni dodaci / Special equipment

- FVA = Jezicak od nerdjajuceg celikal 1.4571; DN 50 ... 250 / PN 16 ... 40
Flange Stainless steel 1.4571; DN 50 ... 250 / PN 16 ... 40
- X = Cev-Ø 12 / 15 / 18 mm / Pipe-Ø 12 / 15 / 18 mm
- H = Podignuta kutija spojnice / Connector box raised

Dimenzije kucista HxBxT u mm /
Dimensions connector box HxWxD in mm

Broj prikljucaka / No. of clamps bis / up to 6 bis / up to 12 bis / up to 18

Aluminium / Aluminum 55 (57) x 80 x 75 55 x 110 x 75 55 x 160 x 75
Polyester / Polyester

Elektricne veze / Electrical Connections

Promenljiva veza / Change-over contact			NO/NC		
Kontakt Br.	Kutija spojnice Ime sponse	Nepovezani deo kabla Boja kabla	Kutija spojnice ime sponse	Nepovezani deo kabla Boja kabla	
Contact No.	Connection box Clamp name	Unconnected cable end Cable colour	Connection box Clamp name	Unconnected cable end Cable colour	
F	crvena / red crna / black	2	bela / white braon / brown	1 2	bela / white braon / brown
K ₁	3	zelena / green	3	zelena / green	
	4	zuta / yellow	4	zuta / yellow	
	5	siva / grey			
K ₂	6	ruzicasta / pink	5	siva / grey	
	7	plava / blue	6	ruzicasta / pink	
	8	crvena / red			
K ₃	9	plava / blue	7	plava / blue	
	10	crvena / red	8	crvena / red	
	11				
K ₄	12	crna / black	9	crna / black	
	13	ljubicasta / violet	10	ljubicasta / violet	
	14				
K ₅	11		11		
	12		12		
K ₆	13		13		
	14		14		

F-Kontakt je po principu 1+2
(oznacjen kao F)

F-contact is in principle 1+2
(marked by F)

Subject to change without prior notice,
errors excepted.

Moguca promena bez prethodnog
obavestenja.