

Magnettauchsonden der Typenreihe T-20...

Typenschlüssel

Grundbezeichnung

Rohrdurchmesser

- 0 = Rohr Ø 16 mm
- 1 = Rohr Ø 15 mm
- 2 = Rohr Ø 12 mm
- 5 = Rohr Ø 8 mm
- 6 = Rohr Ø 8 mm, gebogen
- 7 = Rohr Ø 8 mm, langes Gewinde
- 8 = Rohr Ø 20 mm
- 9 = Rohr Ø 18 mm

Material Rohr und Verschraubung

- PE = Polyethylen
- PP = Polypropylen
- PV = Polyvinylchlorid
- PVDF = Polyvinylidenfluorid
- VA = Edelstahl 1.4571
- MS = Messing
- PT = Edelstahl, Rohr PTFE-beschichtet

Gewinde

- I1/8" = G 1/8" für Innenmontage
- I3/8" = G 3/8" für Innenmontage
- I1/4" = G 1/4" für Innenmontage
- I1/2" = G 1/2" für Innenmontage
- I1" = G 1" für Innenmontage
- A1/2" = G 1/2" für Außenmontage
- A1" = G 1" für Außenmontage
- A1 1/4" = G 1 1/4" für Außenmontage
- A1 1/2" = G 1 1/2" für Außenmontage
- A2" = G 2" für Außenmontage
- A3" = G 3" für Außenmontage
- S = Sonderwunsch

Ausführung

- ohne Angabe = fest
- V = verstellbar (nur bei Außengewinde)

Zusätzliche kontinuierliche Messkette

- ohne Angabe = keine
- K = kontinuierliche Messkette (ab Rohr Ø 12 mm)

Anzahl Schwimmer

- 1x = 1 Schwimmer
- 2x = 2 Schwimmer usw.

Schwimmerausführungen

- 02 = Kugel Edelstahl 44 mm Ø
- 03 = Kugel Edelstahl 52 mm Ø
- 04 = Kugel Edelstahl 62 mm Ø
- 05 = Oval Schwimmer Edelstahl 80 mm Ø
- 06 = Oval Schwimmer Edelstahl 94 mm Ø
- 07 = Kugel Edelstahl 105 mm Ø
- 08 = Zylinder Edelstahl 27 mm Ø
- 09 = Zylinder Edelstahl 44 mm Ø
- 10 = Zylinder PE 52 mm Ø
- 11 = Zylinder PE 78 mm Ø
- 12 = Zylinder PP 19 mm Ø
- 13 = Zylinder PP 25 mm Ø
- 14 = Zylinder PP 52 mm Ø
- 15 = Zylinder PP 78 mm Ø
- 16 = Zylinder PTFE 80 mm Ø
- 17 = Zylinder PVC 78 mm Ø
- 18 = Zylinder PVC 55 mm Ø
- 19 = Zylinder PVDF 52 mm Ø

Anschluss

- PO = Polyesterdose
- AA = Aluminiumdose
- ST = 3fach- oder 6fach-Stecker
- LY = ___ mm Kabel LiYY (Standard 1000 mm)
- SI = ___ mm Kabel Silikon (Standard 1000 mm)
- PT = ___ mm Litze PTFE 0,24 mm² (Standard 1000 mm)
- GF = Überwurfmutter 2 3/4"

Rohrlänge in mm

R = ___ mm

Schaltpunkte in mm

K1 = ___ mm
K2 = ___ mm usw.

Kontakte (Standard monostabil)

NO = Schließer
NC = Öffner
WE = Wechsler

Kontaktverhalten

ohne Angabe = monostabil
bi = bistabil

Begrenzung

(nur bei monostabilen Kontakten)
oben = oben begrenzt
unten = unten begrenzt
0 = ohne

für jeden
Schaltpunkt
angeben

T20

Immersible Magnetic Probes Series T-20...

Type Key

Basic designation

Pipe diameter

- 0 = pipe Ø 16mm
- 1 = pipe Ø 15mm
- 2 = pipe Ø 12mm
- 5 = pipe Ø 8mm
- 6 = pipe Ø 8mm, bent
- 7 = pipe Ø 8mm, long thread
- 8 = pipe Ø 20mm
- 9 = pipe Ø 18mm

Material of pipe and screw union

- PE = Polyethylene
- PP = Polypropylene
- PV = Polyvinylchloride
- PVDF = Polyvinylidene fluoride
- VA = Stainless steel 1.4571
- MS = Brass
- PT = Stainless steel, pipe PTFE-coated

Thread

- I1/8" = G 1/8" for internal assembly
- I3/8" = G 3/8" for internal assembly
- I1/4" = G 1/4" for internal assembly
- I1/2" = G 1/2" for internal assembly
- I1" = G 1" for internal assembly
- A1/2" = G 1/2" for external assembly
- A1" = G 1" for external assembly
- A1 1/4" = G 1 1/4" for external assembly
- A1 1/2" = G 1 1/2" for external assembly
- A2" = G 2" for external assembly
- A3" = G 3" for external assembly
- S = Special request

Design

- without indication = fixed
- V = adjustable (only with external thread)

Additional continuous immersible probes

- without indication = none
- K = continuous immersible probes (starting from pipe Ø 12 mm)

No. of Floats

- 1x = 1 float
- 2x = 2 floats etc.

Float Models

- 02 = ball Stainless steel 44 mm Ø
- 03 = ball Stainless steel 52 mm Ø
- 04 = ball Stainless steel 62 mm Ø
- 05 = oval float Stainless steel 80 mm Ø
- 06 = oval float Stainless steel 94 mm Ø
- 07 = ball Stainless steel 105 mm Ø
- 08 = cylinder Stainless steel 27 mm Ø
- 09 = cylinder Stainless steel 44 mm Ø
- 10 = cylinder PE 52 mm Ø
- 11 = cylinder PE 78 mm Ø
- 12 = cylinder PP 19 mm Ø
- 13 = cylinder PP 25 mm Ø
- 14 = cylinder PP 52 mm Ø
- 15 = cylinder PP 78 mm Ø
- 16 = cylinder PTFE 80 mm Ø
- 17 = cylinder PVC 78 mm Ø
- 18 = cylinder PVC 55 mm Ø
- 19 = cylinder PVDF 52 mm Ø

Connection

- PO = Polyester box
- AA = Aluminum box
- ST = Triple- or sixfold adaptor
- LY = ___ mm = cable LiYY (standard 1000 mm)
- SI = ___ mm = cable Silicone (standard 1000 mm)
- PT = ___ mm = cable PTFE 0,24 mm² (standard 1000 mm)
- GF = sleeve nut 2 3/4"

Pipe length in mm

R = ___ mm

Switch points in mm

K1 = ___ mm
K2 = ___ mm etc.

Contacts (standard monostable)

NO = NO
NC = NC
WE = changeover contact

Contact behavior

without indication = monostable
bi = bistable

Limiting

(only for monostable contacts)
oben = limited upwards
unten = limited downwards
0 = without

provide data
for each
switch point

T20

Anschlussdosen auf Außenverschraubung montiert Connection boxes mounted on external screw union

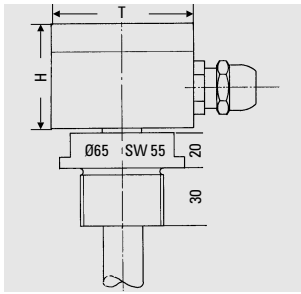

Typ / Type
 RMS-VPP(VPE)-A1 1/2"-AA(PO) = Rohr geschraubt
 Screw pipe
 RVA-VPP(VPE)-A1 1/2"-AA(PO) = Rohr geschraubt
 Screw pipe

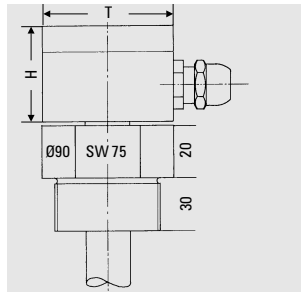

Typ / Type
 RPV-VPV-A2"-AA(PO) = Rohr geklebt
 Pipe glued
 RPP-VPP-A2"-AA(PO) = Rohr geschraubt
 Screw pipe
 RPT-VPT-A2"-AA(PO) = Rohr geklemmt
 Pipe clamped
 RPE-VPE-A2"-AA(PO) = Rohr geschweißt
 Pipe welded

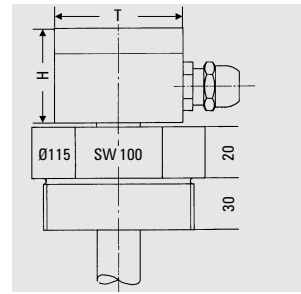

Typ / Type
 RPV-VPV-A3"-AA(PO) = Rohr geklebt
 Pipe glued
 RPP-VPP-A3"-AA(PO) = Rohr geschraubt
 Screw pipe
 RPT-VPT-A3"-AA(PO) = Rohr geklemmt
 Pipe clamped
 RPE-VPE-A3"-AA(PO) = Rohr geschweißt
 Pipe welded

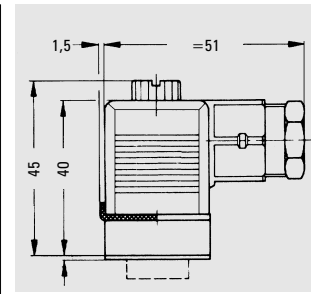

Anschlussstecker / Connection Plug

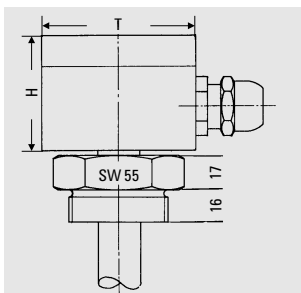

Typ / Type
 RMS-VMS-A1 1/2"-AA(PO) = Rohr hartgelötet
 Pipe brazed
 RVA-VMS-A1 1/2"-AA(PO) = Rohr geschraubt
 Screw pipe
 RMS-VVA-A1 1/2"-AA(PO) = Rohr geschraubt
 Screw pipe
 RVA-VVA-A1 1/2"-AA(PO) = Rohr geschweißt
 Pipe welded

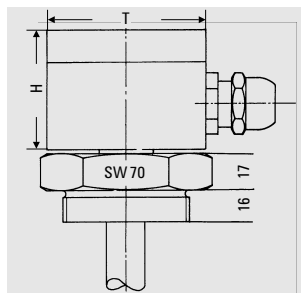

Typ / Type
 RMS-VMS-A2"-AA(PO) = Rohr hartgelötet
 Pipe brazed
 RVA-VMS-A2"-AA(PO) = Rohr geschraubt
 Screw pipe
 RMS-VVA-A2"-AA(PO) = Rohr geschraubt
 Screw pipe
 RVA-VVA-A2"-AA(PO) = Rohr geschweißt
 Pipe welded

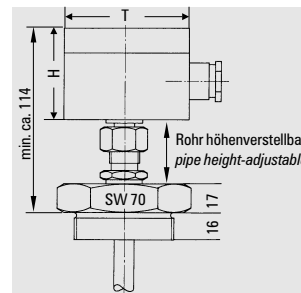

Typ / Type
 RMS-VMS-A2"-AA(PO)-V } = Fixierung mit
 RVA-VMS-A2"-AA(PO)-V } Schneidring
 RMS-VVA-A2"-AA(PO)-V } Secured with
 RVA-VVA-A2"-AA(PO)-V } tube union

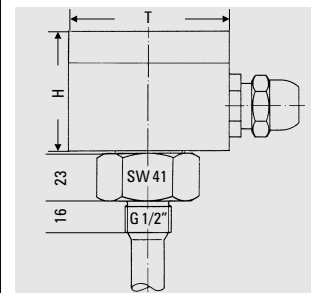

Typ / Type
 RMS-VMS-A 1/2"-AA(PO) = Rohr hartgelötet
 Pipe brazed
 RVA-VMS-A 1/2"-AA(PO) = Rohr geschraubt
 Screw pipe
 RMS-VVA-A 1/2"-AA(PO) = Rohr geschraubt
 Screw pipe
 RVA-VVA-A 1/2"-AA(PO) = Rohr geschweißt
 Pipe welded

Maße Anschlussdosen HxBxT in mm / Dimensions connector socket HxWxD in mm

Anzahl Klemmen / No. of clamps	bis / up to 6	bis / up to 12	bis / up to 18	über / over 18
Aluminium / Aluminum	54x80x75	54x125x80	54x175x80	54x175x80
Polyester / Polyester	55x80x75	55x110x75	55x160x75	55x190x75

Legende / Legend

Bemaßung in mm / Dimensioning in mm

- RMS = Messingrohr / Brass pipe
- RVA = Edelstahlrohr / Stainless steel pipe
- RPE = PE-Rohr / PE pipe
- RPP = PPH-Rohr / PPH pipe
- RPT = Edelstahl-Rohr, PTFE beschichtet / Stainless steel pipe, PTFE-coated
- RPV = PVC-Rohr / PVC pipe
- VMS = Messing-Verschraubung / Brass union
- VVA = Edelstahl-Verschraubung 1.4571 / Stainless steel union 1.4571
- VPE = PE-Verschraubung / PE union
- VPP = PPH-Verschraubung / PPH union
- VPT = PTFE-Verschraubung / PTFE union
- VPV = PVC-Verschraubung / PVC union
- A1 1/2" = Gewinde G1 1/2" für Außenmontage / Thread G1 1/2" for external assembly
- A2" = Gewinde G2" für Außenmontage / Thread G2" for external assembly
- A3" = Gewinde G3" für Außenmontage / Thread G3" for external assembly
- AA = Aluminiumdose / Aluminum box
- PO = Polyesterdose / Polyester box
- V = Verstellbar / Adjustable

Elektrische Anschlüsse / Electrical Connections

Wechsler / Change-over contact			Schließer/öffner NO/NC		
Kontakt Nr.	Anschlussdose Klemmenbezeichnung	Kabelschwanz Kabelfarbe	Anschlussdose Klemmenbez.	Kabelschwanz Kabelfarbe	
Contact No.	Connection box Clamp name	Unconnected cable end Cable colour	Connection box Clamp name	Unconnected cable end Cable colour	
K1	rot / red 1		1	weiß / white	
	schwarz / black 2		2	braun / brown	
	gelb / yellow 3		3	grün / green	
K2	rot / red 4		3	gelb / yellow	
	schwarz / black 5		4	grün / green	
	gelb / yellow 6		5	gelb / yellow	
K3	rot / red 7		5	blau / blue	
	schwarz / black 8		6	rot / red	
	gelb / yellow 9		7	schwarz / black	
K4	10		7	blau / blue	
	11		8	rot / red	
	12				
K5	13		9	schwarz / black	
	14		10	violett / violet	
	15				
K6			11		
			12		
K7			13		
			14		

**Irrtümer und Änderungen vorbehalten.
Subject to change without prior notice, errors excepted.**



BUNDSCHUH GMBH + CO
 An der Hartrbrücke 6
 D-64625 Bensheim

Telefon: +49 (0)6251 8462-0
Fax: +49 (0)6251 8462-72
E-Mail: info@elb-bensheim.de
Info: www.elb-bensheim.de