

BEZBEDNOŠNA TEHNOLOGIJA  
ZA ZAŠTITU ŽIVOTNE SREDINE

SAFETY AND  
ENVIRONMENTAL  
TECHNOLOGY

  
FÜLLSTANDSGERÄTE

## Višestruki pneumatski prekidaci nivoa 2...4

NP-255 PVC (Ø 16 mm)  
NP-256 PVC (mit Schlauch)

*Tip pneumatskih prekidaca nivoa 2...4 NP-255/256 se pokazao kao veoma pouzdan i jednostavan senzor za skeniranje tecnosti, posebno kada se koriste za zaštitu od preliivanja. Tečnosti mogu da budu agresivne, lepljive ili visoko kontaminirane. Prekidac takodje može da se koristi za signalizaciju minimalnih nivoa. Može se koristiti samo u otvorenim rezervoarima bez pritiska.*

*Prekidac nivoa je obezbedjen u dve verzije: PVC ili od nerđajućeg celika (1.4571) i ima membranu prekidaca od Vitona koja reaguje na pojacan pritisak (150mm merac vode).*

*Operativna pouzdanost prekidaca kada se koristi kao prekidac za minimum/maksimum i zaštitu od rada na suvo je garantovana samo ako se rezervoari prazne ili delimicno prazne u redovnim intervalima, pa tako vazduh u cevi pod pritiskom može da se obnavlja.*

## Multiple Pneumatic Level Switch 2...4

NP-255 PVC (Ø 16 mm)  
NP-256 PVC (with hose)

*Multiple pneumatic level switches 2...4, types NP-255/256 have been shown to be very reliable and simple sensors for scanning liquids, in particular when used for overflow protection. The liquids can be aggressive, sticky or highly contaminated. The switches can also be used for signalling minimum levels. They can be used only in open, pressureless containers, tanks etc.*

*The level switches are supplied in PVC or stainless steel (1.4571) and have a membrane changeover switch of Viton which responds to excess pressure (150 mm water guage)*

*Operational reliability of the switches when used as min-max switches and for protection against dry-running is guaranteed only if the containers, tanks etc are emptied or partially emptied at regular intervals, so that the air in the pressure tube can be renewed.*

## Detalji o sistemu

Zbog velikog kapaciteta ukljucivanja, kontaktora, opticki i akusticni sistemi signalizacije mogu biti **direktno** elektricno kontrolisani bez posrednickog releja.

## System Details

Owing to the high switching capacity, contactors, optical and acoustic signalling systems can be **directly** electrically controlled without an intermediate relay.

NP-255



## Tehnicki podaci

	NP-255	NP-252
Glava spoja	PA	PVC
Sistem zaštite EN 60529		
Glava spoja	IP 54	IP 54
Navoj spoja	Od G2"	Od G 2"
Prsten matice	G 2 3/4"	G 2 3/4"
Ježicak veze rezervoara	DN 25	DN 25
Materijal cevi/creva pod pritiskom	PVC	PVC
Materijal veze navoja/ispusta	PVC	PVC
Materijal jezicka	PVC	PVC
Cev/crevo pod pritiskom	Ø16mm	13x2mm
Operativna temperatura	+60°C	+60°C
Max. temperatura supstance	+60°C	+60°C
Veza	Promenljiva veza	
Voltaža uključivanja		
Max. Srebrna	250 VAC	250 VAC
Max. Zlatna	24 VAC	24 VAC
Struja uključivanja		
Max. Srebrna	6 A	6 A
Max. zlatna	100 mA	100 mA
Kapacitet uključivanja	500 VA	500 VA
Operativna tacka mm		
WS* membrane (Viton)	150	150
	±30mm	±30mm
Tacka ispuštanja mm		
WS* membrane (Viton)	90	90
	±30mm	±30mm

\* Uvek se meri od kraja cevi

## Kljuc tipa

Osnovne oznake
Dizajn
5 = Polivinilhlid (PVC) cev 16mm
6 = Polivinilhlid (PVC) crevo
Broj cevi/creva pod pritiskom
2...4 =
Veza navoja
bez = G2"
GF = G2 3/4"
S = specijalni tip
Prekidac pod pritiskom (membrana)
bez = Viton
E = Etilen-propilen-dien-kopolimer (EPDM)
Veza
bez = srebrna veza
1 = zlatna veza
Dužina u mm

NP25

## Technical Data

	NP-255	NP-256
Connecting head	PA	PVC
System of protection EN 60529		
Connecting head	IP 54	IP 54
Connecting thread	from G2"	from G2"
Sleeve nut	from G2 3/4"	from G2 3/4"
Container connection flange	from DN 25	
Material pressure tube/hose	PVC	PVC
Material screw connection/nozzle	PVC	PVC
Material flange	PVC	PVC
Pressure tube / hose Ø	16 mm	13x2 mm
Operating temperature	+60 °C	+60 °C
Medium temperature max.	+60 °C	+60 °C
Contact	change-over contact	
Switching voltage		
Silver max.	250 VAC	250 VAC
Gold max.	24 VAC	24 VAC
Switching current		
Silver max.	6 A	6 A
Gold max.	100 mA	100 mA
Switching capacity	500 VA	500 VA
Operating point mm WS* membrane (Viton)	150	150
	±30 mm	±30 mm
Release point mm WS* membrane (Viton)	90	90
	±30 mm	±30 mm

\* Always measured from the tube end

## Type Key

Basic designation
Design
5 = Polyvinylchloride (PVC) tube 16mm
6 = Polyvinylchloride (PVC) hose
Number of pressure tubes / pressure hoses
2...4 =
Connecting thread without indication = G 2"
GF = sleeve nut G 2 3/4"
S = special type
Pressure switch (membrane) without indication = Viton
E = Ethylene-Propylene-Diene-Copolymer (EPDM)
Contact without indication = Silver contact
1 = Gold contact
Length in mm

NP25

## Dimensioni crtez Dimensional Drawing



Dimenzije u mm / Dimensioning in mm

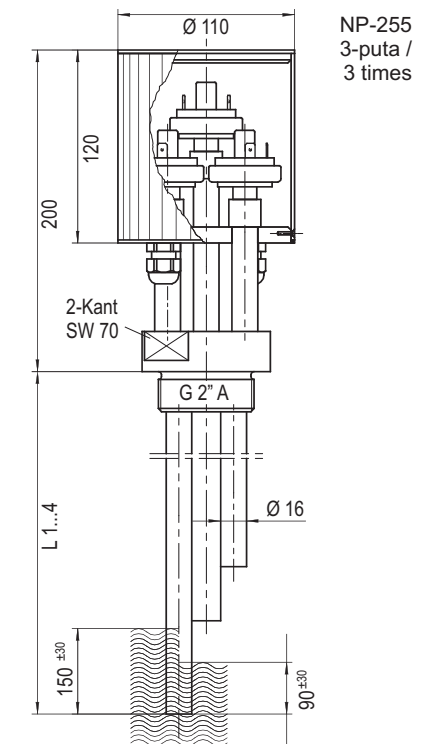

Dimenzije u mm / Dimensioning in mm

Moguće izmene bez prethodne najave.

Subject to change without prior notice, errors excepted.