

Kutije spojnice za spoljasnju vezu zavrtnja Connection boxes mounted on external screw union

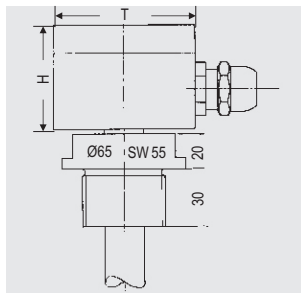

Tip / Type
 RMS-VPP(VPE)-A1½"-AA(PO) = cev zavarena
 Screw pipe
 RVA-VPP(VPE)-A1½"-AA(PO) = cev zavarena
 Screw pipe

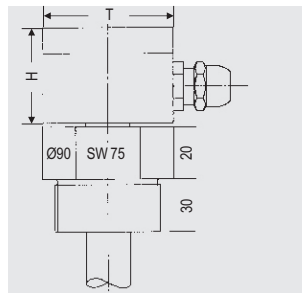

Tip / Type
 RPV-VPV-A2"-AA(PO) = cev zalepljena
 Pipe glued
 RPP-VPP-A2"-AA(PO) = cev zavrnuta
 Screw pipe
 RPT-VPT-A2"-AA(PO) = cev pod sponom
 Pipe clamped
 RPE-VPE-A2"-AA(PO) = cev zavarena
 Pipe welded

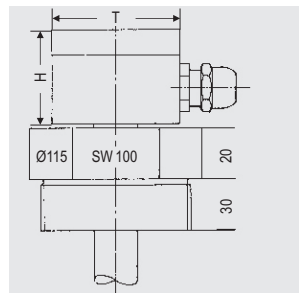

Tip / Type
 RPV-VPV-A3"-AA(PO) = cev zalepljena
 Pipe glued
 RPP-VPP-A3"-AA(PO) = cev pod sponom
 Screw pipe
 RPT-VPT-A3"-AA(PO) = cev pod sponom
 Pipe clamped
 RPE-VPE-A3"-AA(PO) = cev zavarena
 Pipe welded

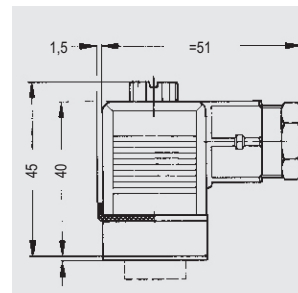

Utikac / Connection Plug

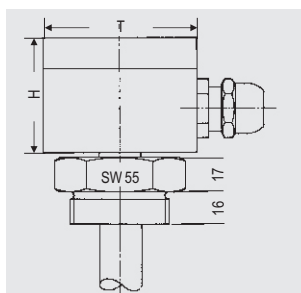

Tip / Type
 RMS-VMS-A1½"-AA(PO) = cev zavarena
 Pipe brazed
 RVA-VMS-A1½"-AA(PO) = cev pod sponom
 Screw pipe
 RMS-VVA-A1½"-AA(PO) = cev pod sponom
 Screw pipe
 RVA-VVA-A1½"-AA(PO) = cev zalemljena
 Pipe welded

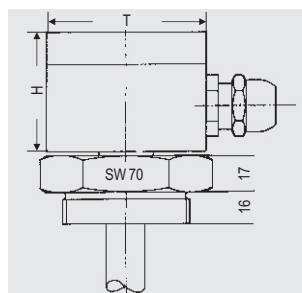

Tip / Type
 RMS-VMS-A2"-AA(PO) = cev zavarena
 Pipe brazed
 RVA-VMS-A2"-AA(PO) = cev pod sponom
 Screw pipe
 RMS-VVA-A2"-AA(PO) = cev pod sponom
 Screw pipe
 RVA-VVA-A2"-AA(PO) = cev zalemljena
 Pipe welded

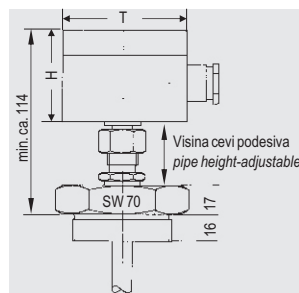

Tip / Type
 RMS-VMS-A2"-AA(PO)-V } = obezbedjeno
 RVA-VMS-A2"-AA(PO)-V } spojem cevi
 RMS-VVA-A2"-AA(PO)-V } Secured with
 RVA-VVA-A2"-AA(PO)-V } tube union

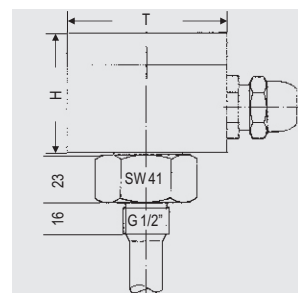

Tip / Type
 RMS-VMS-A½"-AA(PO) = cev zavarena
 Pipe brazed
 RVA-VMS-A½"-AA(PO) = cev pod sponom
 Screw pipe
 RMS-VVA-A½"-AA(PO) = cev pod sponom
 Screw pipe
 RVA-VVA-A½"-AA(PO) = cev zalemljena
 Pipe welded

dimenzije u mm / Dimensions connector box HxWxD in mm

Br spona / No. of clamps	do / up to 6	do / up to 12	do / up to 18	preko / over 18
Aluminijum / Aluminum	54x80x75	54x125x80	54x175x80	54x175x80
Poliester / Polyester	55x80x75	55x110x75	55x160x75	55x190x75

Elektricne veze

Kutija spoja/utikac nepovezani kraj kabla

- 1 = iznad belo
 2 = ispod braon
 3 = duzina zeleno

Electrical Connections

Connector box/plug

Unconnected cable end

- 1 = above white
 2 = below brown
 3 = length green

Legenda / Legend

Dimenzije u mm / Dimensioning in mm

- RMS = Mesingana cev / Brass pipe
 RVA = cev od nerđajućeg celika / Stainless steel pipe
 RPE = PE-cev / PE pipe
 RPP = PPH-cev / PPH pipe
 RPT = cev od nerđajućeg celika, obložena PTFE /
 Stainless steel pipe, PTFE-coated
 RPV = PVC-cev / PVC pipe
 VMS = Mesingani spoj / Brass union
 VVA = spoj od nerđajućeg celika 1.4571 /
 Stainless steel union 1.4571
 VPE = PE-spoj / PE union
 VPP = PPH-spoj / PPH union
 VPT = PTFE-spoj / PTFE union
 VPV = PVC-spoj / PVC union
 A1½" = navoj G1½" za spoljasnju montazu /
 Thread G1½" for external assembly
 A2" = navoj G2" za spoljasnju montazu /
 Thread G2" for external assembly
 A3" = navoj G3" za spoljasnju montazu /
 Thread G3" for external assembly
 AA = Aluminijumsko kuciste / Aluminum box
 PO = Poliester kuciste / Polyester box
 V = podesivo / Adjustable

Moguće izmene bez prethodne najave.

Subject to change without prior notice,
 errors excepted.