

BEZBEDNOŠNA TEHNOLOGIJA  
ZA ZAŠTITU ŽIVOTNE SREDINE

SAFETY AND  
ENVIRONMENTAL  
TECHNOLOGY

**E.L.B.**  
FÜLLSTANDSGERÄTE

11-01-04E

**Instrumenti za merenje nivoa tecnosti  
Serija TK-309  
Nerdjajuci celik 1.4571**

**Liquid Level Measuring Instruments  
Type TK-309  
Stainless steel 1.4571**

**Tehnicki podaci  
Tip TK-309**

Spoj	Vidite podatke kutije
Sistem zaštite EN 60529	IP 65 kutija/utikac IP 55 kabl
Tip plovska	07
Kabl	1000mm silikon 0.5mm <sup>2</sup>
Dužina cevi	Max. 6000 mm
Operativna temperatura	Max. 130°C
Operativni pritisak	Max. 20bar
Gustina tecnosti	0.58 g/cm <sup>3</sup>
Rezolucija	7,5mm, 10mm, 15mm, 20mm ili 1%, 2%, 5% u zavisnosti od modela
Dodaci	R/I transduducer TK-100 Vidite odeljak 14-01-01E

**Technical Data  
Type TK-309**

Connector	see box data
Sys. of protection EN 60529	IP 65 box / plug IP 55 cable
Float type	07
Cable	1000 mm Silicone 0,5 mm <sup>2</sup>
Pipe length	max. 6000 mm
Operating temperature	max. 130 °C
Operating pressure	max. 20 bar
Media density	0,58 g/cm <sup>3</sup>
Resolution	7,5 mm, 10 mm, 15 mm, 20 mm or 1 %, 2 %, 5 % dep. on model
Accessories	R/I Transducer TK-100 see folder 14-01-01-E

**Dimenzioni crtez  
Dimensional Drawings**

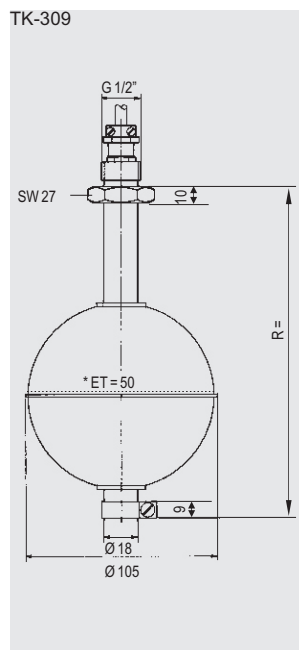

TK-309

\*Dubina uranjanja pri gustini 1  
Immersion depth at density 1  
Dimenzije u mm / Dimensioning in mm

**Kljuc tipa  
Tip TK-309**

**Type Key  
Type TK-309**

Osnovne oznake (cevi Ø18mm) / Basic designation (pipe Ø 18 mm)

Materijal spoja cevi i zavrtnja / Material of pipe and screw union  
VA = Nerdjajuci celik 1.4571 / Stainless steel 1.4571

Navoj / Thread

I 1/2" = G 1/2" za unutrašnju montažu / G 1/2" for internal assembly  
A 1" = G 1" za spoljašnju montažu / G 1" for external assembly

Dizajn / Design

bez indicacije / without indication = fiksni / fixed  
V = podesiv (samo sa spoljašnjim navojem) /  
adjustable (only with external thread)

Modeli plovska / Float models

07 = kugla, nerdjajuci celik 105mmØ / ball Stainless steel 105 mm Ø

Veza / Connection

PO = Kutija od poliestera / Polyester box

AA = Kutija od aluminijuma / Aluminum box

ST = trostruki ili šestostruki adapter / triple adaptor

SI = \_\_\_ mm Kabl Silikon (Standard 1000 mm)

\_\_\_ mm cable Silicone (standard 1000 mm)

Dužina cevi u mm / Pipe length in mm

R = \_\_\_ mm

Rezolucija / Resolution

7,5 = 7,5 mm

10 = 10 mm

15 = 15 mm

20 = 20 mm

1% = 1% (izlaz 4...20 mA postavljen u kutiji spoja od poliestera ili aluminijuma)

(outlet 4...20 mA set in PO or AA box)

2% = 2% (izlaz 4...20 mA postavljen u kutiji spoja od poliestera ili aluminijuma)

(outlet 4...20 mA set in PO or AA box)

5% = 5% (izlaz 4...20 mA postavljen u kutiji spoja od poliestera ili aluminijuma)

(outlet 4...20 mA set in PO or AA box)

TK309

Moguće izmene bez prethodnje najave.

Subject to change without prior notice,  
errors excepted.